

Utdrag fra midtveispresentasjonen i kurset «Bylandskapet som sosial arena», høsten 2017
NMBU-studenter i Flesberg kommune.



An including and sustainable landscape for everyone



"Including" is about

Democratic landscape theory:
everyone has the right to
landscape

Landscape Participatory Science:
Design is co-creation between
local communities and designers/
planners/architects



Sustainable

The Brundtland commission's
definition:
environmental, social, economic

Resilience

Ecological Democracy +
Landscape Participatory
Science

Connection with nature

Connected with nature



Distanced from nature

"Dugnadsånd" vs. Loneliness



Identity



Utdrag fra midtveispresentasjonen i kurset «Bylandskapet som sosial arena», høsten 2017
 NMBU-studenter i Flesberg kommune.

Today's Flesberg



"This is how I feel:
I'm the tree in the middle and the rest is everyone else."



"The shadow of Kongsberg"



"There's nothing to do."

Water Boring
 Lack of unformal meetingplaces
 Lonely Deppa Nothing to do
 Desolate Animals
 Train Cafe Forest Fields

Tomorrows Flesberg



"People need to open their heart for something new"



"Hope for skate park"

Don't need to change that much, I'm happy the way things are"





"More people. More activities. More cooperation"

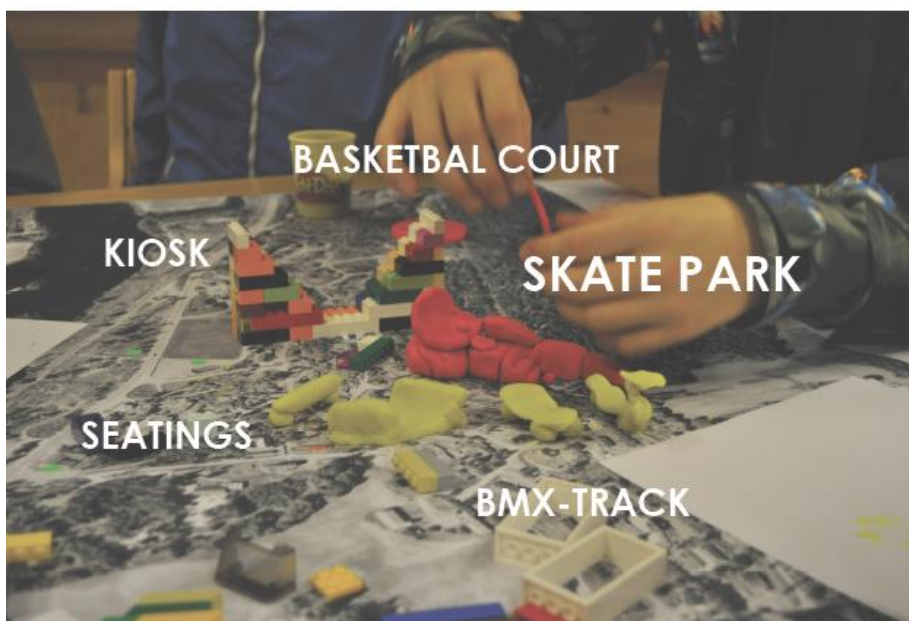

Utdrag fra midtveispresentasjonen i kurset «Bylandskapet som sosial arena», høsten 2017
 NMBU-studenter i Flesberg kommune.

S **TRENGTHS**

Culture heritage "Ildsjeler"	Close to Kongsberg "Middelalderuka"
Clubs and associations	Communities
The river	Previous participation
Partnership	Numedal identity
Nature	Social control
History	Strong and varied businessess
Cabin residents "Dugnad"	Proximity between municipal government and the people "First in Numedal"- the road

W **EAKNESSES**

Easy to fall outside	Child poverty
Youth vs adults	No municipal plan
Bullying/ Loneliness	Poor economy
Lack of integration	Weak population growth
Public transport	"Bygdedyret"
Partnership	Meeting places
4 centers	Lack of interaction

O **PPORTUNITIES**

The river	Numedal identity
Tourism	Kongsberg
Public transport	Infrastructure
Nature and recreation	New bridge
Strengthen identity	Hydroelectric power (economic)
Empty premises and places	Municipality merging
	Cabin tourism
	Flesberg - Kongsberg distance

T **REATS**

Dispersed settlement	Kongsberg
Shutdown of services	Automation and digitization
Internet, social media	Increased car traffic
Long distances	Hydroelectric power (ecological)
	National guides, focus on cities and NTP
Poor connections	New bridge

Main goals

An including and sustainable community and landscape for everyone

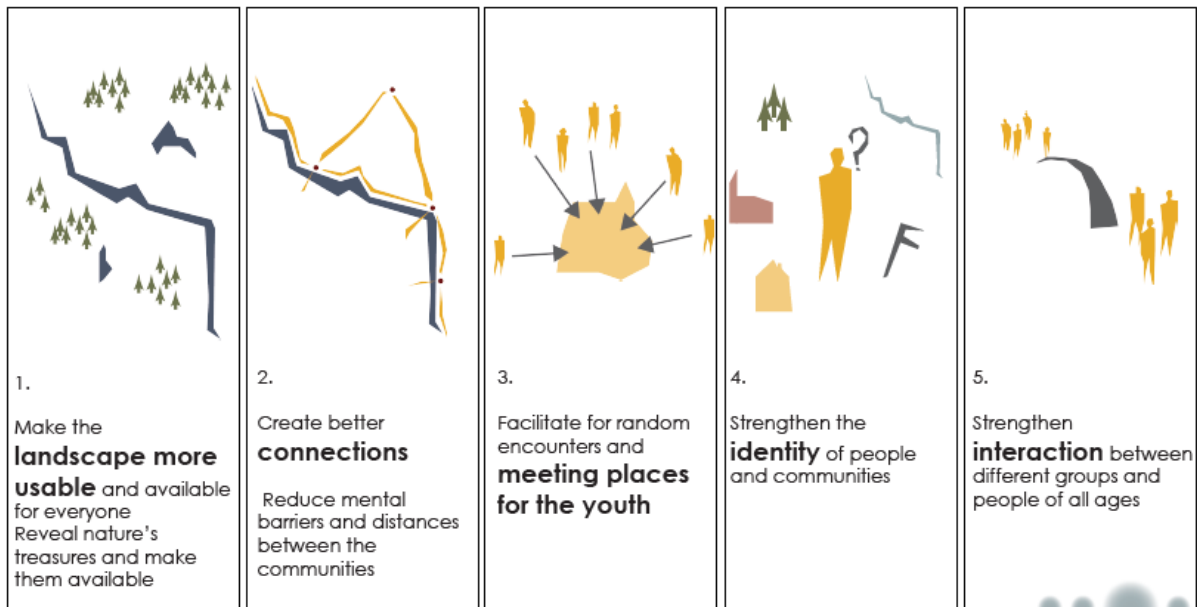

Utdrag fra midtveispresentasjonen i kurset «Bylandskapet som sosial arena», høsten 2017
NMBU-studenter i Flesberg kommune.

Vision:

An including
and sustainable
landscape for everyone



Ulike studenter/studentgruppers tilnærming til problemstillingen og utfordringsbildet i Flesberg

Kristina Reed, Hilde Kristin Kvinge, Else Maire Nes



Bridge people

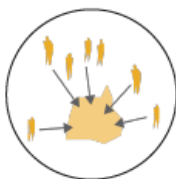

Meetingplaces



Identity

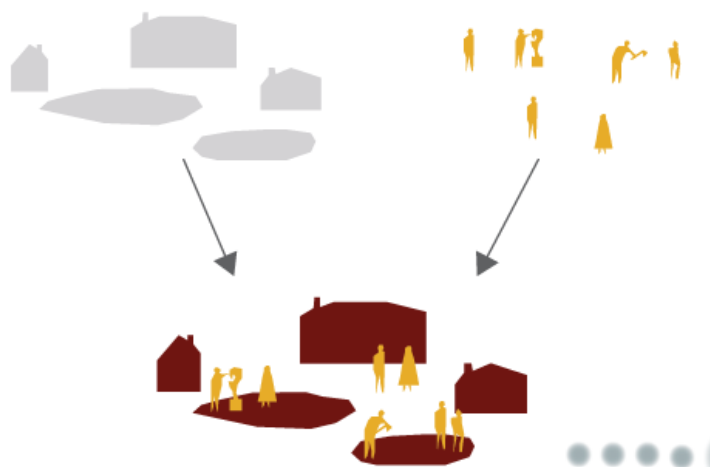
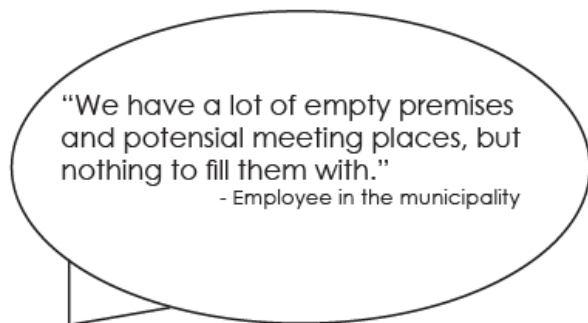

Utdrag fra midtveispresentasjonen i kurset «Bylandskapet som sosial arena», høsten 2017
NMBU-studenter i Flesberg kommune.

Jostein Rykkeliid

Identity

In what ways can landscape contribute to creating a positive identity?



Pia Sundsvold

Flesberg 2.0

Enhancing identity

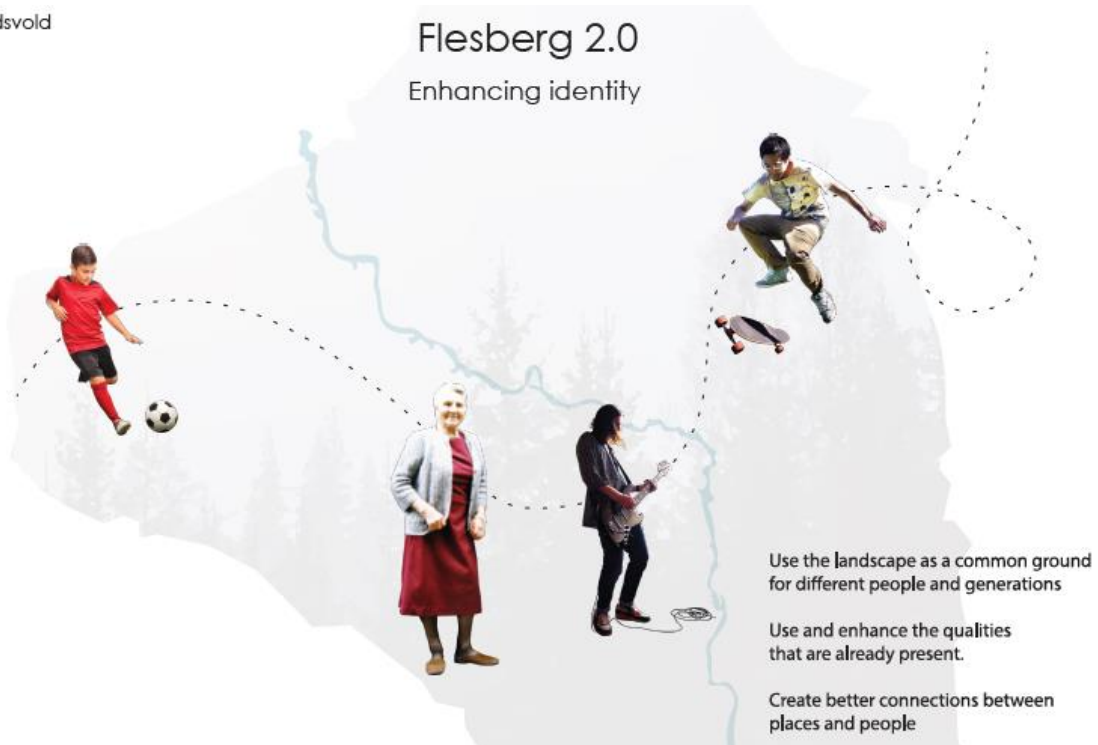

Thea Marum

Create a social meeting place in Svene

that the teenagers create and define themselves



Utdrag fra midtveispresentasjonen i kurset «Bylandskapet som sosial arena», høsten 2017
 NMBU-studenter i Flesberg kommune.

Roar Sløgedal

A small scale urban feeling in Svene

The pupils expressed their need for an informal meetingplace



Meetingplace and marketplace go together

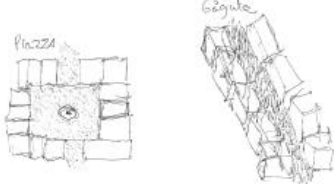

Ingvild Ottesen

The new Flesberg school

- an important "nærmiljøanlegg" in Flesberg municipality

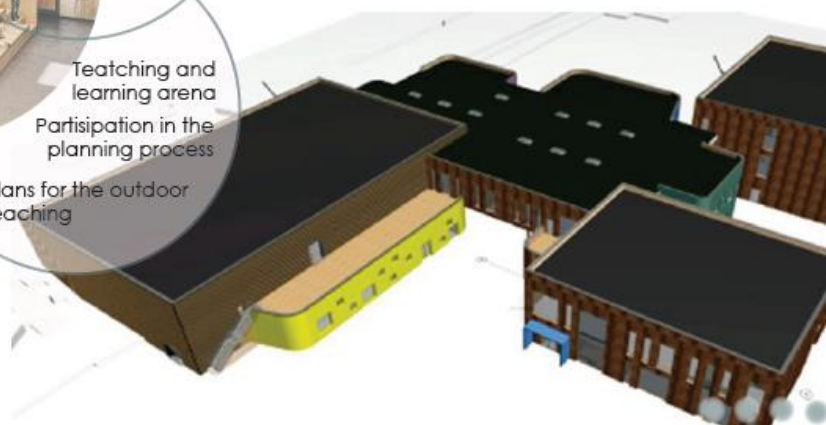

Jonas Collett

Svene - the entrance to Numedal

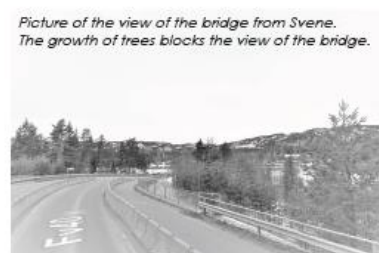
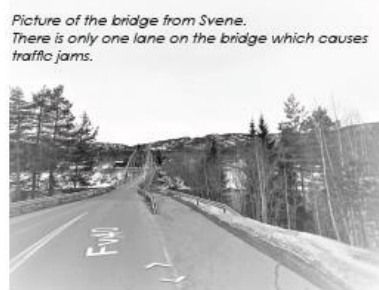
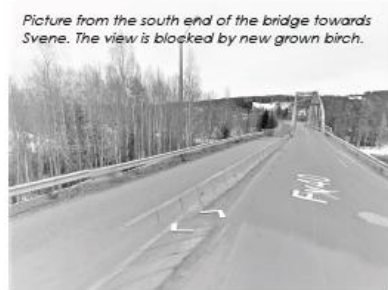

The center of alternative leisure activities for the youth

Attract youth from all of Flesberg, Kongsberg and the cabins

Tools:

- Nice views and open lines
- Lower the speed
- Create opportunities to stop
- Break barriers
- Sacred places

Silje Myhre

How can the river be a bigger part of the local community?

Social meeting places and activities

Proud of the river

Connection to the river

Flesberg village



Pia Haukali

The river

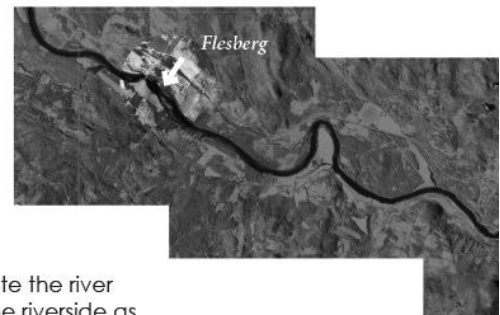

Activate the river and the riverside as a means to a more sustainable and including Flesberg.

How can the river be used to connect the three villages and create a common ground, pride and identity?

The youth is the main focus but with an aim to create a development that is beneficial for the whole society.